

DT640 MAX

UTILITY VACUUM CRAWLER

Fully submersible, battery operated, versatile rubber wheeled utility robot.



 DEEP TREKKER™

DT640 MAX

PORTABLE VACUUM ROBOT

Built for cleaning sediment and sludge from the bottoms of reservoirs and tanks, the DT640 MAX is an easier, safer and more cost effective alternative to draining assets or utilizing divers for cleaning.



50m (164ft)
depth rating



Up to 8-hour
battery operation



Portable



Extremely durable



360° turn radius

Get an instant visual on hard to reach and impossible to access environments.



36" Vacuum head

Cover more ground with four 2" nozzles powered by a single rear intake.



Raise and Tilt 40°

Maintain control of the vacuum head with the ability to raise, lower and tilt the vacuum head 40-degrees.

GENERAL SPECIFICATIONS

Crawler General Specs

Width :	419 MM (16.5")
Height :	398 MM (15.7")
Length :	851 MM (33.5")
Weight (in air) :	50 KG (110 LB)
Material :	Stainless Steel, Aluminum, High Strength Acrylic
Depth Rating :	50 M (164 FT)
Wheels:	Rubber 2WD
Camera :	700 TVL 0.0001 lux
Operating Temp :	-5°C to 40°C (23°F – 104°F)
Max Speed:	24m / minute
Turn Radius :	0 mm (0")
Warranty :	1 Year – Parts and Labor (optional 2-3 yrs)

Crawler Electrical System

System Voltage :	19.2 VDC
Battery Run Time :	Up to 8 Hours
Sensors :	Incline, Roll, Leak, Camera Pan/Tilt

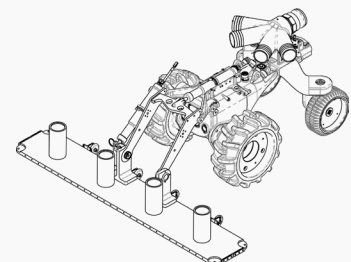
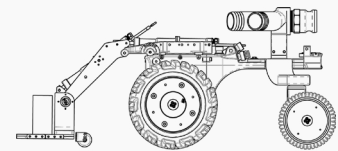
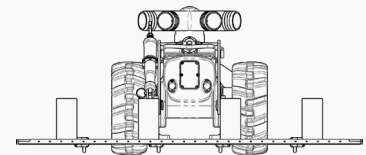

Deep Trekker reserves the right to amend these specifications at any time without notice.

KEEP SERVICES ONLINE

Conduct reservoir or tank cleaning with the DT640 MAX without interrupting service. Avoid the dangers of having divers in the water and pump sediment from water tanks using the Deep Trekker robotic vacuum system.

TACKLE JOBS TWICE AS FAST

The big brother of the DT640 Utility Crawler, the DT640 MAX covers more ground and moves twice as fast to tackle the biggest of jobs. Perfect for reservoirs, the DT640 MAX readily handles sediment and mud.

DT640 MAX | TOUGH JOBS WITH EASE

With a wider tail and updated wheels, the DT640 MAX can take on the toughest jobs with ease. Enhanced traction and higher speed paired with the ability to cover more ground make the DT640 ideal for substantial cleaning jobs including reservoirs and large tanks.

Like the original DT640, the DT640 MAX is built with anodized aluminum and utilizes our innovative magnetically coupled drive assemblies at the wheels, eliminating the need for ongoing maintenance.



Pan/tilt/zoom elevated camera



650 lumen LED floodlights

Users can upgrade their current DT640 into the DT640 MAX in minimal time.



Raise and lower vacuum head 40 degrees



Pan/tilt/zoom camera

Hose connector



EASY TO USE CONTROLLER



Weatherproof handheld controller



Record video inspections with voice over via DVR

Easily clean sediment and sludge from reservoirs and tanks. Operate the DT640 MAX with its splash-proof controller. The easy to use control system reduces the learning curve for beginner operators.

Record your own video inspections and provide operators with instant visuals.

5.6" LCD Controller	✓	✓
Forward Facing Body Camera	✓	✓
PT Elevated Camera pan (360)° and tilt (280°)	✓	✓
50M Depth Rating	✓	✓
Tether Length	75M	75M
Tether Reel	✓	✓
Sensor Pack incline, roll, leak, camera pan/tilt	✓	✓
Rubber Wheels	✓	✓
LED Lights	✓	✓
Software Integration	✓	✓
18" Dual 2" Intake Vacuum	✓	-
36" Quad 2" Intake Vacuum	-	✓
Electric Arch Kit	✓	✓
Dual Connection Kit	✓	-
Quad Connection Kit	-	✓
Carrying Cases	✓	✓
Fully Assembled and Tested	✓	✓
Warranty	One Year	One Year
EXTRA ADD-ONS		
Pressure Washer Kit	14" Single 1.5" Intake Vacuum	Service Kits
Dozer Kit	24" Dual 2" Intake Vacuum	External Floodlights
Cygnus Guage Kit	DVR (Digital Video Recorder)	Sonar

UNDERWATER REMOTELY OPERATED VEHICLES & ROBOTS

With over a decade of proven performance, Canadian company, Deep Trekker, is one of the largest underwater ROV manufacturers in the world – delivering high quality, robust and portable underwater robots to industries ranging from aquaculture to municipal contracting, military and defense, search and rescue, shipping, infrastructure and more.

Head office

830 Trillium Dr
Kitchener, ON
Canada

DT640MAX_ENG_0221_02

Chile Office

Dr Martín 580
Puerto Montt, Los Lagos
Chile



[deeptrekker.com](https://www.deeptrekker.com)
sales@deeptrekker.com